

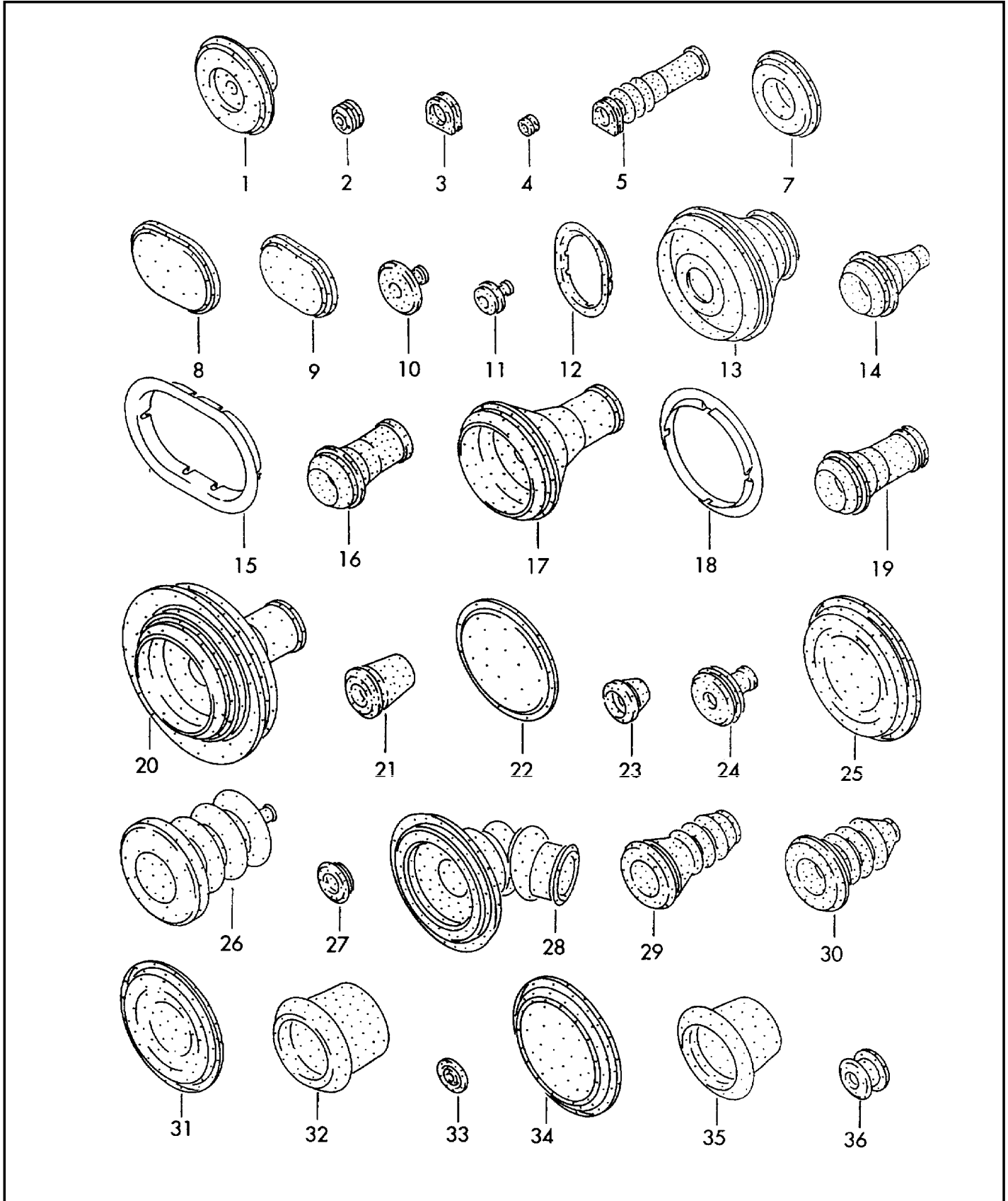

# ETKA

Model	Year	MG	SG	Illustration	Restrictions	UPD	9:51	12.02.2009
EL	2008	9	71	976-08		739		





# ETKA

Model	Year	MG	SG	Illustration	Restrictions	UPD	9:51	12.02.2009
EL	2008	9	71	976-08		739		

Pos	Part Number	Description	Remark	Qty	Model
		grommet for body			
1	867 971 872	grommet	39,5/8	X	
2	803 971 873	grommet	12/8	X	
3	251 971 878	grommet	19	X	
4	803 971 878	grommet	9/6	X	
5	--- --- ---	no longer available	19/11,5	X	
7	155 971 904	plug	33/20	X	
8	333 971 904	plug	28,7/38,8	X	
9	333 971 904 A	plug	22,5/38,5	X	
10	111 971 905	grommet	28/5	X	
11	321 971 905	grommet	16,5/1,7	X	
12	251 971 905 A	grommet	62X38/59X35	X	
13	--- --- --- .	discontinued / replacement:	251 971 905 C		
14	171 971 905 B	grommet	33,5/6	X	
15	--- --- ---	no longer available			
16	171 971 905 C	grommet	33,5/11	X	
17	251 971 905 C	grommet	52X16	X	
18	357 971 905 C	plug	51	X	
19	820 971 908 A	grommet	38MM	1	
20	357 971 905 E	grommet	46/16	X	
21	111 971 907	grommet	24/8,5	X	
22	191 971 907	grommet	46/39	X	
23	311 971 907	grommet	23,5/4	X	
24	021 971 907 A	grommet	33/9	X	
25	357 971 908	plug	60	X	
26	4A0 971 908	grommet	35/5	X	
27	431 971 908	grommet	23,5	X	
28	443 971 908	grommet	50/16	X	
29	--- --- ---	no longer available	40/15	X	
30	--- --- ---	no longer available	40/8	X	



# ETKA

Model	Year	MG	SG	Illustration	Restrictions	UPD	9:51	12.02.2009
EL	2008	9	71	976-08		739		

Pos	Part Number	Description	Remark	Qty	Model
31	357 971 908 A	plug	48MM	X	
32	893 971 908 A	grommet	37/16	X	
33	191 971 908 B	plug	19,5	X	
34	357 971 908 B	plug	50/54	X	
35	--- --- ---	no longer available			
36	893 971 908 F	grommet	6X12,5	X	