

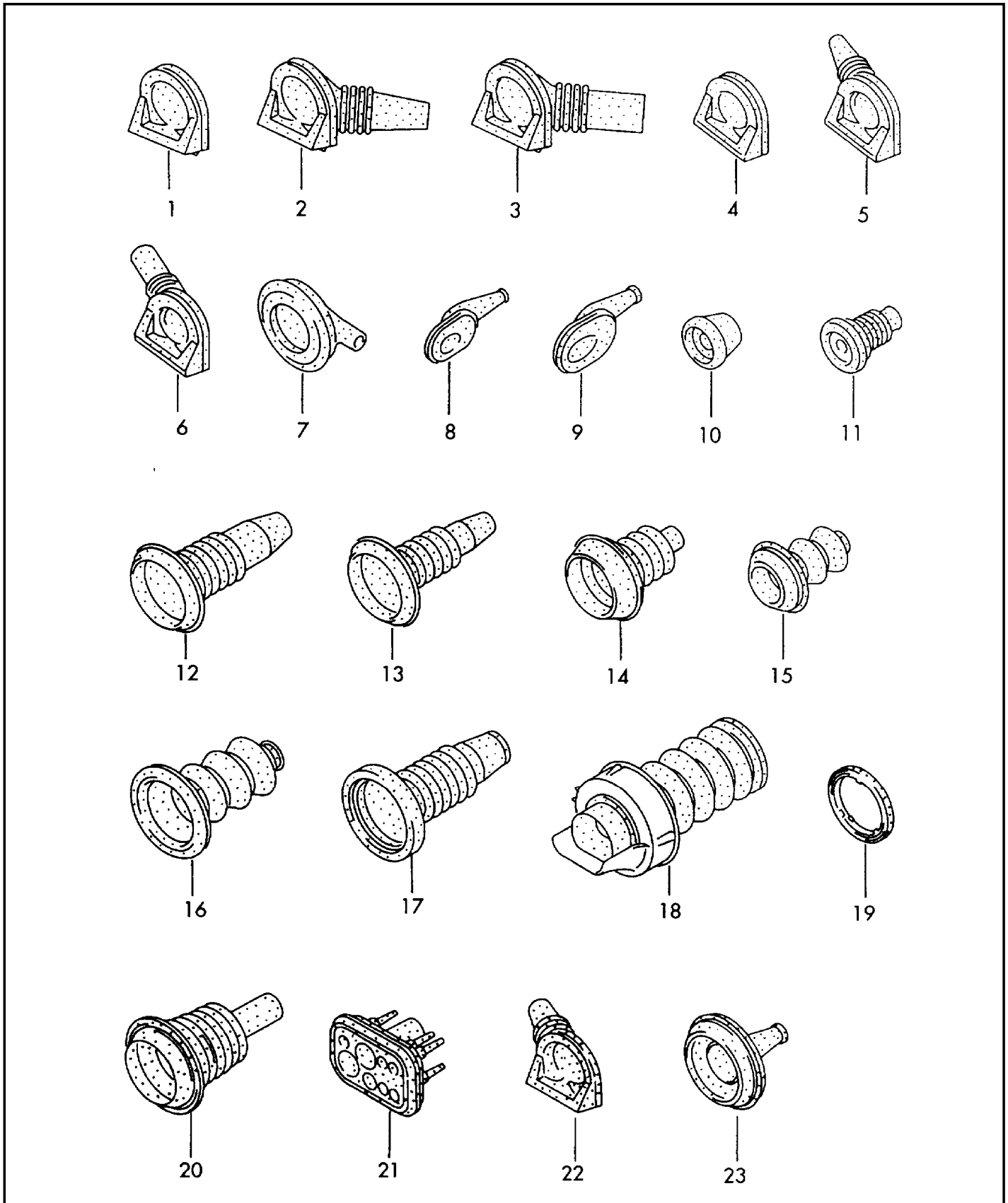

# ETKA

Model	Year	MG	SG	Illustration	Restrictions	UPD	9:52	12.02.2009
EL	2008	9	71	976-10		739		





# ETKA

Model	Year	MG	SG	Illustration	Restrictions	UPD	9:52	12.02.2009
EL	2008	9	71	976-10		739		

Pos	Part Number	Description	Remark	Qty	Model
		grommet for body			
1	1H2 971 908	plug		X	
2	1H0 971 905 K	grommet	39/12	X	
(2)	1H0 971 905	grommet	39/13	X	
3	1H0 971 905 D	grommet	39/19	X	
4	4E0 971 909 C	grommet		X	
5	1H0 971 905 A	grommet	31/6	X	
6	1H0 971 905 E	grommet	31/15	X	
7	4D0 971 908 B	grommet	41/8	X	
8	1H5 971 907 C	grommet		X	
9	1H5 971 907 B	grommet		X	
10	357 971 907	grommet	23,5/10	X	
11	1H0 971 919	grommet	24/7	X	
12	1H0 971 840 B	grommet	12,5X46	X	
13	1H0 971 840	grommet	46/10,5	X	
14	8A0 971 841	grommet	47	X	
15	--- --- ---	no longer available			
16	893 971 908 G	grommet	51X13	X	
17	1H0 971 840 A	grommet	52,3/17	X	
18	3A0 971 611	bellows	41,5/31,5	X	
(18)	1H4 971 611 A	bellows		X	
19	3A0 959 750	o-ring		X	
		only for:	3A0 959 740 6N0 959 740		
20	1H0 971 840 C	grommet		X	
21	8D0 971 871 E	grommet	60X40	X	
22	1H0 971 905 G	grommet	39/13	X	
23	6N0 971 915 B	grommet	52,3/9	X	