

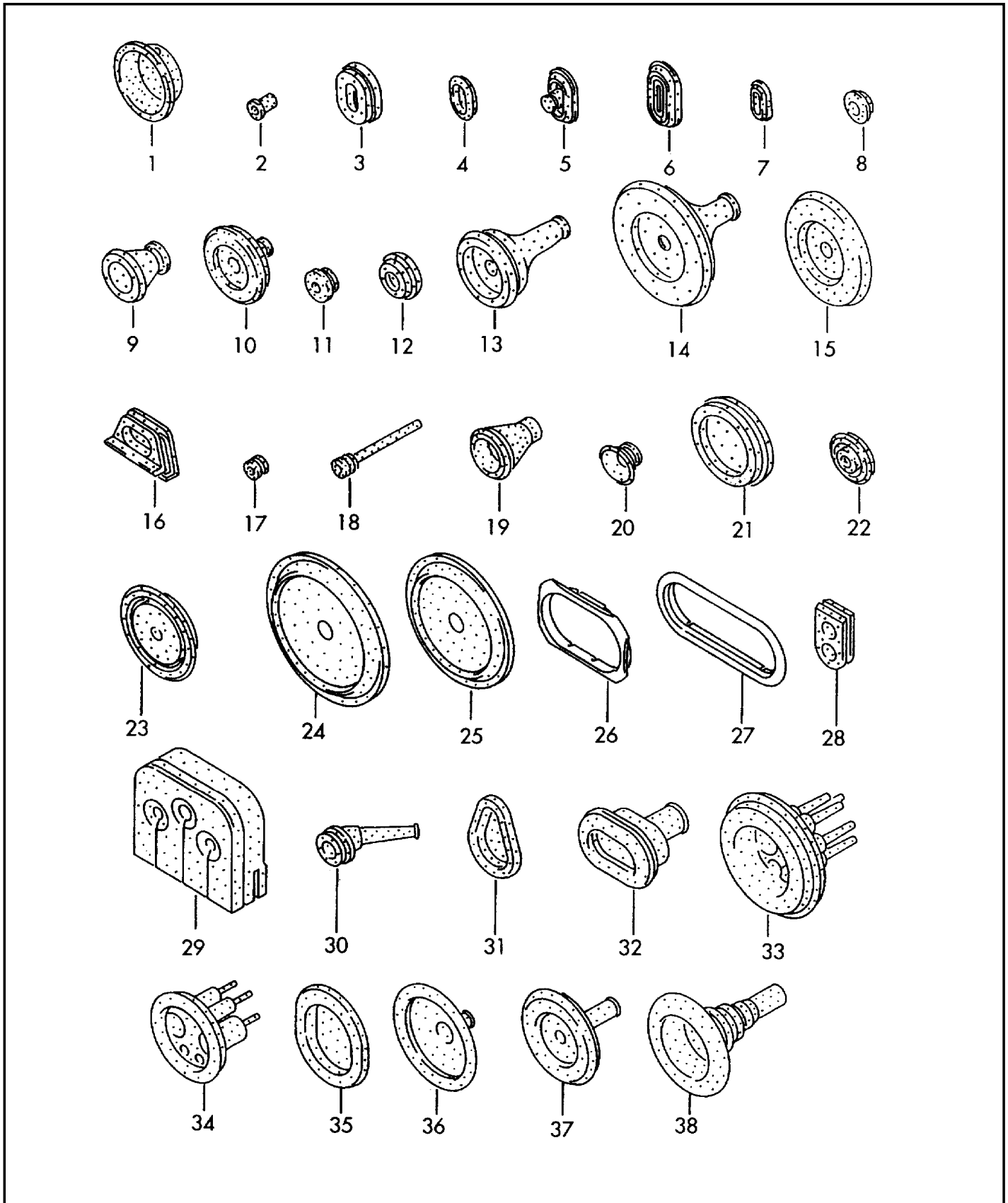

ETKA

Model	Year	MG	SG	Illustration	Restrictions	UPD	9:52	12.02.2009
EL	2008	9	71	976-09		739		





ETKA

Model	Year	MG	SG	Illustration	Restrictions	UPD	9:52	12.02.2009
EL	2008	9	71	976-09		739		

Pos	Part Number	Description	Remark	Qty	Model
		grommet for body			
1	--- --- ---	no longer available			
2	811 971 909	sealing bush	11,5X3,2	X	
3	171 971 910	plug	22X15/14X7	X	
4	--- --- ---	no longer available			
5	331 971 910	grommet	21,8X11/4	X	
6	701 971 910	plug	28X14	X	
7	1H6 971 910 A	plug	6,8X15,5	X	
8	111 971 911 A	grommet	16,5	X	
9	--- --- ---	no longer available			
11	171 971 913	grommet	12,5	X	
12	311 971 913	grommet	12,5/2	X	
13	357 971 913 A	grommet		X	
14	1H0 971 913 B	grommet	46/7	X	
15	147 971 915	grommet	39,5/8	X	
16	--- --- ---	no longer available		X	
17	481 971 915	grommet	9,5/2,4	X	
18	--- --- ---	no longer available	10/4	X	
19	323 971 919	grommet	28/11	X	
20	--- --- ---	no longer available			
21	191 971 926 B	grommet	33,5	X	
22	191 971 928	grommet	27	X	
23	867 971 928	plug	38	X	
24	1H0 971 908	plug	70	X	
25	1H4 971 908	plug	64	X	
26	701 971 905 B	grommet	45X30/41X26	X	
27	701 971 905 A	grommet	65X22/61X19	X	
28	701 971 878	grommet	20X23	X	
29	8G0 971 239 B	grommet	19X6	X	
30	895 955 754 A	grommet		X	



ETKA

Model	Year	MG	SG	Illustration	Restrictions	UPD	9:52	12.02.2009
EL	2008	9	71	976-09		739		

Pos	Part Number	Description	Remark	Qty	Model
31	1H0 971 908 E	plug	30X20X16	X	
32	701 957 861	grommet	34X24/8	X	
33	4A2 971 871	grommet		X	
34	4A0 971 908 B	grommet	31	X	
35	7J0 971 904	plug		1	
36	701 971 908 A	grommet	38,8/4	X	
(36)	3B0 971 913 E	grommet	40/5,4 MM	X	
(36)	3B0 971 913 G	grommet	32/5,4 MM	X	
37	1H0 971 913 C	grommet	33,5,6/10	X	
38	8A0 971 908	grommet	32/3,5	X	