

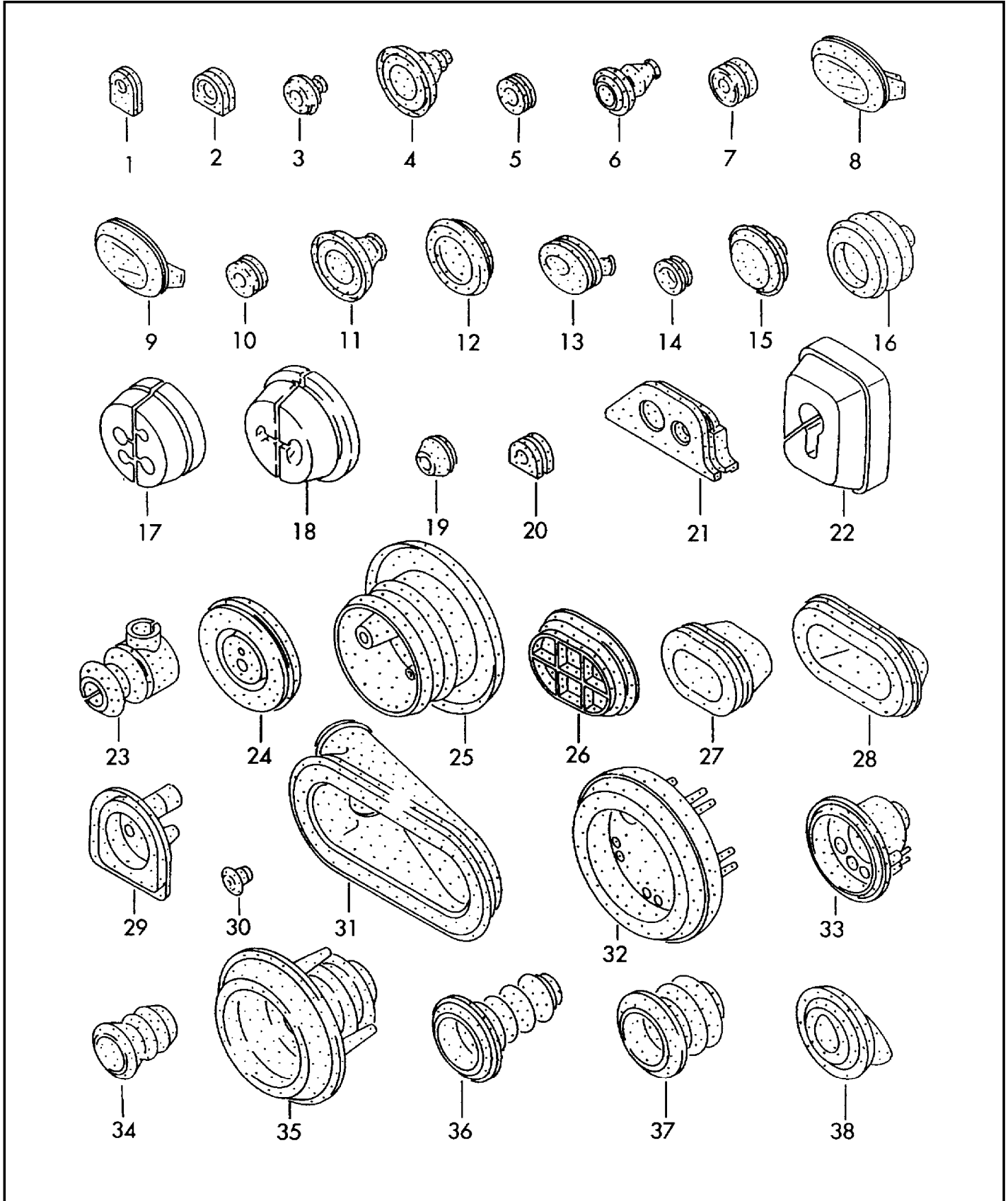

ETKA

Model	Year	MG	SG	Illustration	Restrictions	UPD	9:51	12.02.2009
EL	2008	9	71	976-07		739		





ETKA

Model	Year	MG	SG	Illustration	Restrictions	UPD	9:51	12.02.2009
EL	2008	9	71	976-07		739		

Pos	Part Number	Description	Remark	Qty	Model
		grommet for body			
1	--- --- ---	no longer available	12/5	X	
2	--- --- ---	no longer available			
3	311 949 149 B	grommet	13/5	X	
4	823 953 331	grommet	20/5	X	
5	331 955 754	grommet	13/9	X	
6	445 955 754 A	grommet	13/4,5	X	
7	431 955 995	grommet	16/5	X	
8	1J0 955 998 C	grommet	36X25/5,5/3	X	
9	--- --- --- .	discontinued / replacement:	1J0 955 998 C	X	
10	113 957 855	grommet	14/9	X	
11	803 957 855	grommet	22/6,4	X	
12	171 957 857	plug	28	X	
13	111 957 861	grommet	22,5X14,5/6,1	X	
14	--- --- ---	no longer available			
15	251 957 861	grommet	33/6	X	
16	357 957 861	grommet	28/6,4	X	
17	8L0 959 841	grommet	61X80/14+10MM	X	
18	853 959 841	grommet	40	X	
19	803 959 843	grommet	12,5/4	X	
20	--- --- ---	no longer available			
21	893 971 239 A	grommet		X	
22	441 971 841	grommet	52X37X2	X	
(22)	8E0 971 841 D	foam insert a-pillar	left a. right	2	
23	443 971 841	grommet	27/10	X	
24	4A0 971 841 A	grommet	41	X	
25	4A0 971 841 B	grommet	50	X	
26	4A0 971 841 E	grommet	48X32	X	
27	447 971 863	grommet	34,5X19/ 25X15,5	X	



ETKA

Model	Year	MG	SG	Illustration	Restrictions	UPD	9:51	12.02.2009
EL	2008	9	71	976-07		739		

Pos	Part Number	Description	Remark	Qty	Model
28	447 971 863 A	grommet	56X27/40X11	X	
29	893 971 863 C	grommet	31	X	
30	--- --- ---	no longer available			
31	321 971 870	grommet	81,5X41/20	X	
32	4A0 971 871	grommet	61	X	
33	447 971 871	grommet	59/16	X	
34	--- --- ---	no longer available	33,5/18	X	
35	893 971 871	grommet	56,5/15	X	
(35)	4F0 971 871 G	grommet	51,0/12	X	
36	443 971 871 A	grommet	48,5/11	X	
37	811 971 871 A	grommet	47/15	X	
38	431 971 872	grommet	36/6	X	